

SY-KLONE[®]

INTERNATIONAL

OPTIMAX[®] INSTALLATION KIT FOR KOMATSU PC300/350LC-8 EXCAVATOR

Sy-Klone kit part number:
IN0051

For model numbers:

- PC300/350LC-8
- PC300HD/350HD-8

Installation time: 3 hours

Before Installation:

Review the complete installation instructions and evaluate the following items:

- Where is the AC condensor core located? Will it have to be discharged and moved to be able to remove and install the new deck plate provided in the kit?
- Are there any other obstructions or concerns related to the installation of the new deck plate, i.e. hoses, wires, etc.?
- Open the engine compartment and locate the mounting locations for the 2 inch cross over tube brackets to insure there are no conflicts.
- Inspect the muffler. The muffler must be in good condition.
- Check the contents of the box to verify that all parts are included.

Technical Support:

Web: www.sy-klone.com

Email: support@sy-klone.com

Phone: +1 904-448-6563 ext. 1310



Parts included in Kit

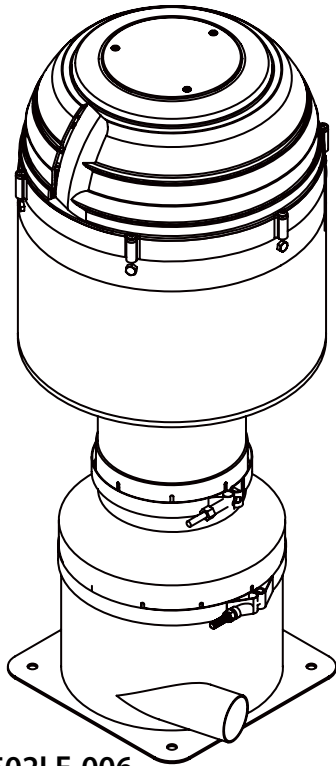

X9502LF-006
OPITMAX Dual-Stage Precleaner
Assembly with Basket Screen

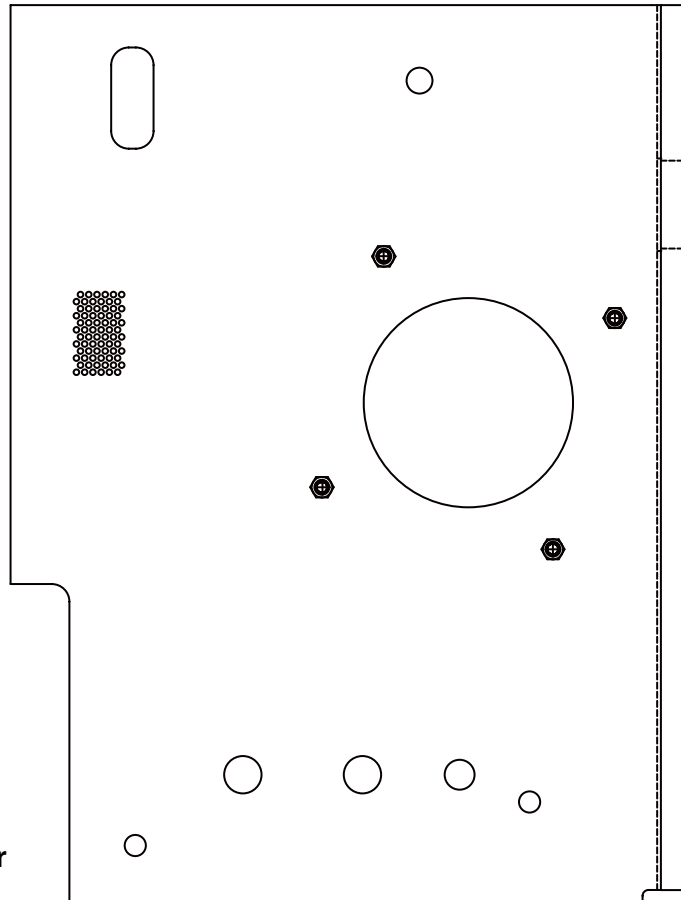

XAD0041 OPTIMAX Deck Plate

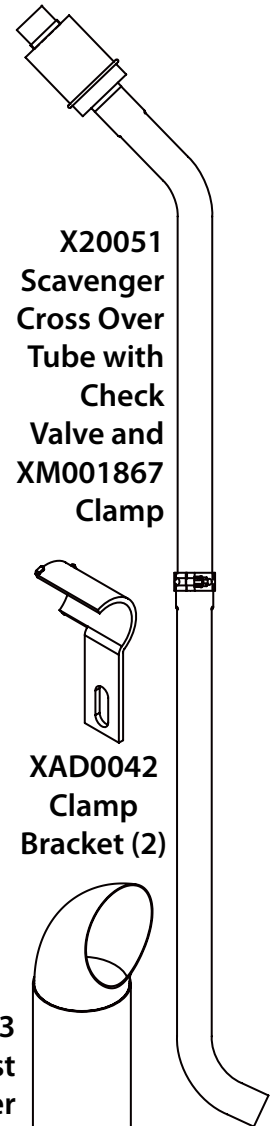

X20051
Scavenger
Cross Over
Tube with
Check
Valve and
XM001867
Clamp

XAD0042
Clamp
Bracket (2)

XAD0043
Exhaust
Scavenger
Muffler Extension
with XM001668
Clamp

NOT PICTURED:

- 91200 Stainless Steel 2-inch Wormgear Clamp (7)
- 91675W Stainless Steel 6.75-inch Wormgear Clamp (2)
- 91688 Stainless Steel 6.88-inch T-bolt Clamp
- Edge Molding (60 inches)
- FH20-001 2-inch Diameter Scavenger Hose (54-inch length)
- KT0009 Vacuator Cap Assortment and Cable Tie
- XHEATSHD Heat Shield Thermo Sleeve 2.5-inch inner diameter (42-inch length)
- X66070 6 to 7-inch Expansion Adapter
- X6H6 6-inch Hump Hose
- XHW0036 Metric M10 x 1.5 Hex Nut (4)
- XHW0037 M10 Lock Washer (4)
- XHW0039 M10 X 1.5 X 25 Bolts (4)

Installation Instructions

1. Open the engine cover.
2. Remove the deck plate that covers the engine air filter housing. This may require moving the AC condenser core or other obstacles.
3. Remove the foam seal from around the air filter housing inlet.



4. Mount 6 to 7-inch expansion adaptor (X66070) onto air filter housing inlet.



5. Attach the hump hose (X6H6) to the 6 to 7-inch expansion adaptor inlet and clamp.
6. Place upper clamp on the hump hose.
7. Install the new deck plate (XAD0041). The deck plate holds the side panel sheet metal and doors in alignment. Make sure to check alignments before tightening mounting bolts. **NOTE:** Deck plate in kit is painted.



8. Place the OPTIMAX Dual-Stage Precleaner on the new deck plate, mating OPTIMAX outlet to the hump hose attached to the air inlet. **NOTE:** Check that the orientation of the scavenger port on the OPTIMAX is pointed toward the engine cover.



9. Bolt the OPTIMAX to the new deck plate using M10 bolts, lock washers and nuts.

10. Position and tighten the upper hump hose clamp. Check both clamps on the hump hose to ensure they are tight.



11. Remove the Evacuator Valve from the engine air filter housing cover and replace with the appropriate size Dump Valve Cover and cable tie (XE0017).



12. Cut exhaust pipe 2 inches above weld.

13. Install exhaust scavenger muffler extension (XAD0043). Make sure that the scavenger tube on the side of the exhaust scavenger muffler extension is aligned to the latch side of the engine cover.

Note:

The rain cap may differ from that pictured.



Installation Instructions, continued

- Close the engine cover until the cove contacts the exhaust scavenger muffler extension (XAD0043). Mark the engine cover and prepare to cut the engine cover to allow the engine cover to close completely and latch.
- Cut the engine cover. Cover engine with welding blanket prior to cutting. It is best to cut the opening small and then increase the opening to the correct size. (A second cut (later) will also require use of the welding blanket.)



15.
Note: The rain cap may differ from that pictured.

- Assemble scavenger cross over tube (X20051) as pictured and connect using clamp (XM001867).
- Install three clamp brackets utilizing the existing bolts shown in picture. The "open" side of the bracket should face the front/cab of the machine. Finger tighten only.
- Position scavenger cross over tube as shown. Attach to clamp brackets with clamps (91200).
- Raise scavenger cross over tube approximately 1/4 inch

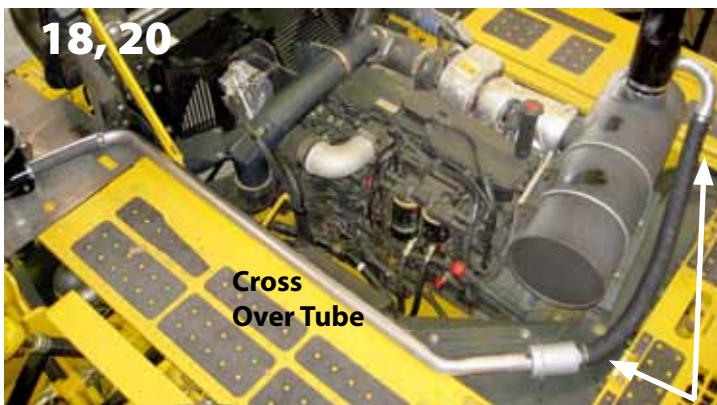

Heat shield should completely cover this section of scavenger hose.

above deck plating, then tighten three clamp bracket mounting bolts.

- Cover the Scavenger hose that runs from the exhaust scavenger to the check valve side of the cross over tube with heat shield (XHEATSHD). The heat shield should be cut approximately 3 inches longer than the hose so that the ends of the heat shield can be rolled back inside itself approximately 1.5 inches at each end. The heat shield should cover the entire length of the hose and go under the clamps (91200).



- Connect the exhaust scavenger to the cross over tube at the check valve end with the heat shield covered cross over hose.
- Close the engine cover and mark where cross over tube and the engine cover contact. The engine cover will need to be cut so that it can close completely and latch.
- Cut the engine cover where the cross over tube and engine cover contact.
- After cutting the openings in the engine cover, install the edge molding supplied in the kit.



- Close the engine cover and check clearance and that the cover will completely close. If it does not, make appropriate corrections.
- Review installation and double check all clamps and bolts to insure proper installation.