

OPTIMAX[®] Dual-Stage Precleaner Installation Kit for Terex RH40, RH120, RH170, RH200, RH340, RH370, and RH400 mining shovels.

Sy-Klone part number: IN0086

One kit is required per filter housing.



Purpose:

The OPTIMAX[®] Dual-Stage Precleaner ejects the majority of particles through the ejection slot in the first stage of the system. Remaining fine particulate is exhausted through the scavenger connection in the second phase of precleaning. This unit has been designed to perform well in extreme debris conditions such as landfill environments, providing dramatically extended filter life. While routine cleaning and maintenance is not required, it is recommended that you perform periodic inspections to ensure the ejection slot does not become blocked. See the Video Library on www.sy-klone.com for a demonstration.

PRIOR TO INSTALLING OPTIMAX:

- The Optimax Dual-Stage Precleaner should always be installed with the machine turned off.
- Check the scavenging system equipped, verify suction coming from the system. You can use a rag or piece of paper to verify suction. Do not let go of the rag. If there is no suction the muffler scavenger is clogged or the muffler needs to be replaced.

Check suction with a rag or piece of paper. Also make sure that check valve is working correctly and is not rusted on the inside.



Caution: If the muffler needs to be replaced stop installation and recover, plug or reconnect the scavenger tube. Tell the customer of the problem. Finish installation after the muffler is corrected.

- Check the restriction gauge by running the machine at high idle, record the results on a data sheet.
- Shut machine down and turn off master power switch.

Replacement Parts:

Stock code	Description	Quantity
KT0009	DVP CAP PLUG KIT	1
AD0300	BLOCKING PLATE SPACER	1
AD0301	BLOCKING PLATE	1

Also included in kit:

Description	Quantity
RTV BLACK	1
1/4"-14 X 1 SELF DRILLING SCREW	10
3/8" SCREWDRIVER POWER BIT	1

Installation Time: <1 hour



AD300 - SPACER



AD301 - BLOCKING PLATE



KT0009



OPTIMAX
(SOLD SEPARATELY)

Technical Support

www.sy-klone.com

support@sy-klone.com

+1 (904) 448-6563 ext. 1310

OPTIMAX[®] Dual-Stage Precleaner Installation Kit for Terex RH40, RH120, RH170, RH200, RH340, RH370, and RH400 mining shovels.

MACHINE PREPARATION:

1. Remove and retain the existing scavenger hoses and connections.
2. Check all hoses and clamps for reuse.
3. Cap the scavenger port on the filter housing.
4. Inspect the filter cover for proper sealing against the housing. Replace cover if necessary.
5. Clean the intake surface of the housing.

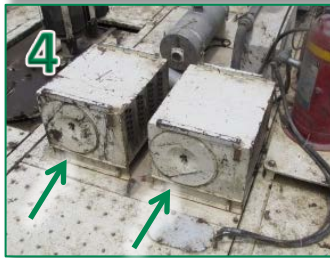
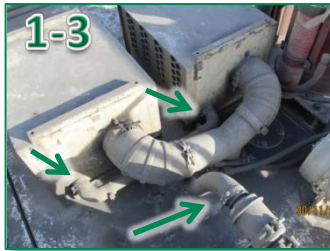

6. Place the AD0300 spacer in the area marked by the yellow dotted line and mark the locations of the holes.
7. Use a 1/8-inch drill bit and pre-drill the holes.



8. Apply RTV sealant on the mating surface of the AD0301 blocking plate. Place the spacer on the blocking plate.

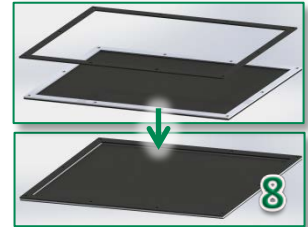

9. Apply RTV sealant to the intake surface and bolt the plates in place using the self drilling screws.



OPTIMAX[®] INSTALLATION:

1. Clean the top of the filter housing.



2. Use the template to mark the mounting and outlet holes for the OPTIMAX[®] Dual-Stage system. **Note:** The distance between the OPTIMAX[®] scavenger ports needs to remain the same as the previous scavenger ports.

3. Apply RTV and bolt the OPTIMAX[®] to the housing.
4. Reconnect the scavenger system.

